

MYSTERY HOUSE

BOOK ROOM
GO <obj>

TOM	BLOND	PLUMBER
SAM	BRUNETTE	MELTANIC
SALLY	REDBLAD	SEAMSTRESS
DR. GREEN	BRUNETTE	SURGEON
JOE	BRUNETTE	GRAVEDIGGER
BILL	BLOND	BUTCHER
DAISY	BLOND	COOK

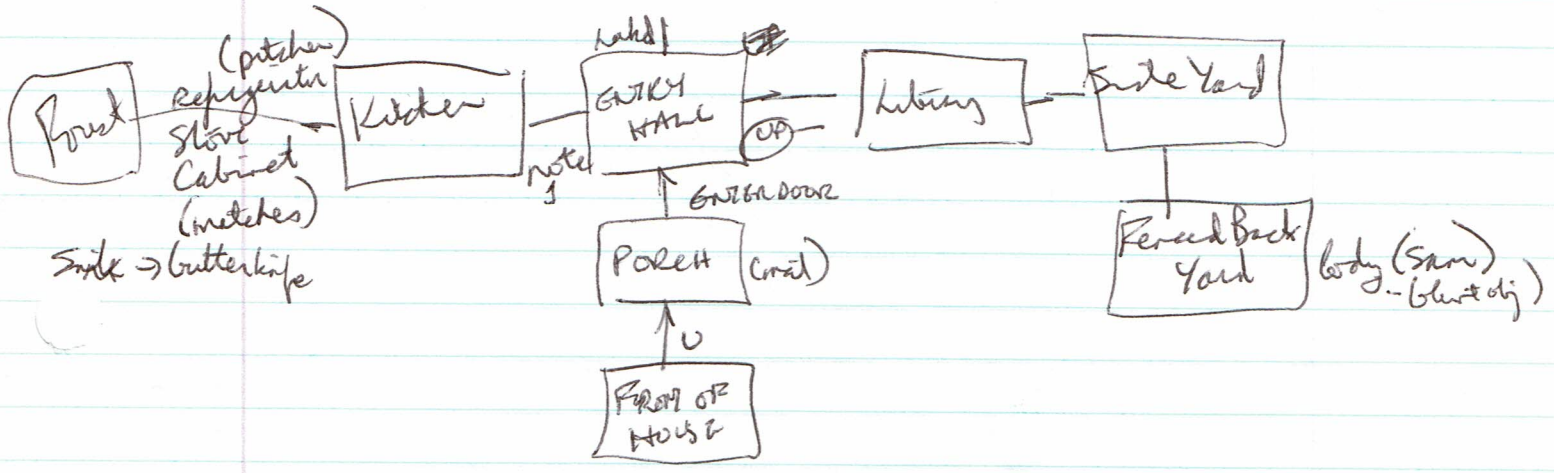

Note 1: Valuable Jewels Are Hidden In This House. Finders-Keepers.

Light Match (for keys)

Note 2: 7-6=1 Then I Am Done!

Time Zone (Blue: Europe, Africa, Australia, Antarctica, Asia, NA, SA, IP (Interplanetary))

(Orange: 400 MILBC, 1000BC, 50BC, 1000AD, 1400AD, 1700AD, 2082AD, 4082AD.)

(Button: Home)

(Lever:

- just enter "1400AD" or "AFRICA"
- instead of TURN BLUE TO <setting>
- "LEAVE MACHINIC"